

The Future of the Pillars at Nine Mile Corner Lafayette YMCA – April 12, 2022

Panelists

Bill Meyer – Boulder Rotary Club

Jason Marmor – Colorado Department of Transportation

Denise Grimm – Boulder County

For more information, see 9milecornerpillars.com.

Evaluating the Desirability of Pillar Alternatives

Location – The original monument was intentionally located at the “entrance” to the City of Boulder

- How important is this location?
- Is the alternative location comparable or otherwise acceptable?

Function – The original monument was intended to flank Arapahoe Road and form a visual Gateway

- How important is it that the monument serve as a gateway?
- Will the alternative fulfill this function?

Purpose – The monument was intended to honor soldiers from Boulder County who served in WWI

- Has the original location fulfilled that purpose?
- Will the alternative adequately fulfill this purpose?

Evaluating the Feasibility of Pillar Alternatives

Ease of Site acquisition (purchase, donation, public space)

Ability to obtain Zoning/Permits

Ease of public access and safety (parking, bike or walking paths, conflicts with traffic)

Vehicular safety

Permanency (likelihood of future redevelopment)

Responsibility for future maintenance

Potential for vandalism

Potential costs:

- Repair/reconstruction of current location

- Site acquisition costs at new location

- Design costs

- Site preparation costs at new location (surveying, grading, sidewalks, entrances, parking, utilities)

- Legal/administrative costs (site acquisition, permitting)

- Restoration/relocation expenses

- Amenities (signage, landscaping, lighting)

Funding

- Current costs

- Future Maintenance

PROPOSED ALTERNATIVES

1. Demolish pillars
2. Leave pillars in place and:
 - a. Do nothing
 - b. Restore and maintain
 - c. Restore, maintain, and enhance with signage, etc.
3. Relocate pillars to flank US 287 south of Arapahoe
4. Relocate pillars to flank Arapahoe between current location and 95th Street
5. Relocate both pillars to single spot (*i.e.*, not flanking a roadway) in the vicinity of the current location
 - a. NE corner of Arapahoe and US 287 (Arapahoe Ridge)
 - b. Nine Mile Corner Development
 - c. Erie property immediately to the south (old Prince Reservoir No. 1)
 - d. Tebo Development
 - e. Silo Development
 - f. Intersection of Arapahoe and 95th St.
 - h. Lafayette YMCA
 - i. Intersection of Arapahoe and 111th St.
6. Relocate pillars to another spot away from current location
 - a. Flanking entrance to Legion Park
 - b. Flanking entrance to US 36 overlook
 - c. Flanking walkway or roadway on CU campus
 - d. Flanking entrance to Flagstaff Mountain Park
 - e. Entrance to an open space location
 - f. Boulder Mall
 - g. Infinite Walk of Peace (adjacent to Boulder Public Library)

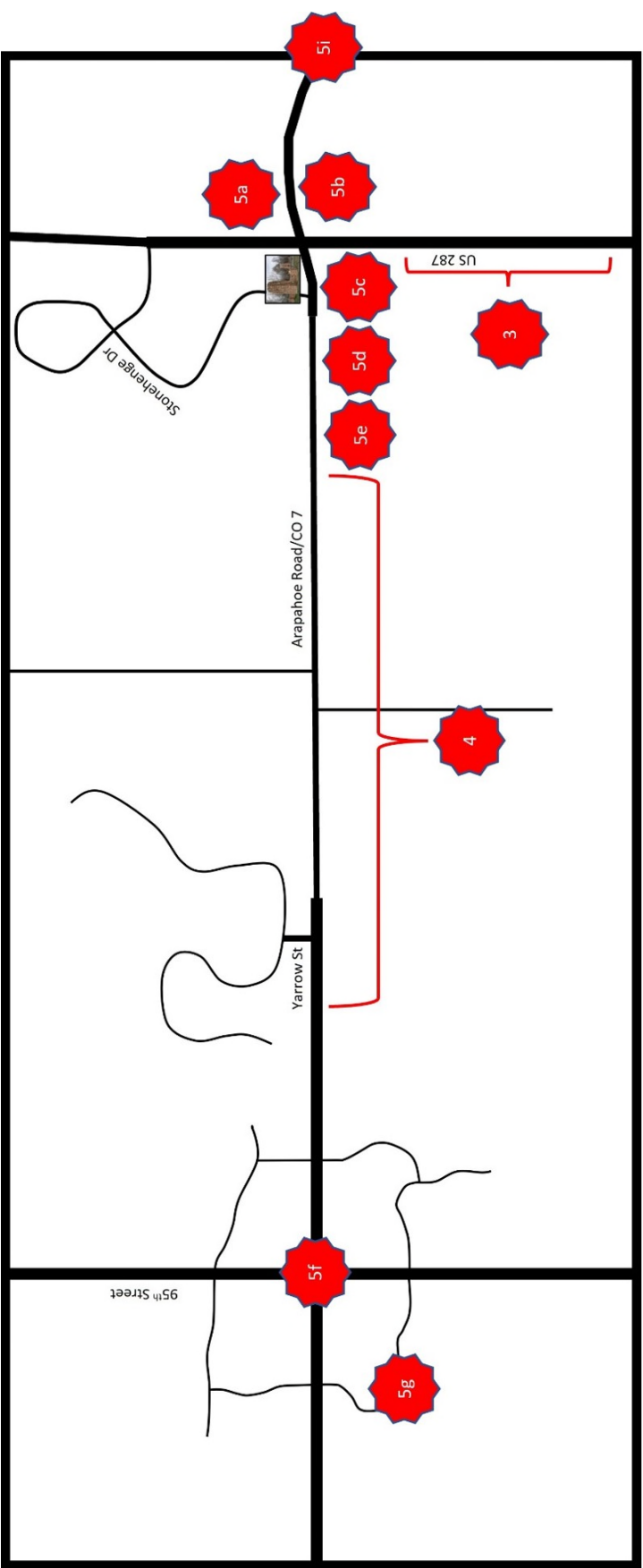

Potential Nearby Relocation Sites