



Community Planning & Permitting

Courthouse Annex • 2045 13th Street • Boulder, Colorado 80302
Mailing Address: P.O. Box 471 • Boulder, Colorado 80306
303-441-3930 • www.BoulderCounty.gov

HISTORIC PRESERVATION ADVISORY BOARD

Thursday, March 5, 2026, 6 p.m.

Public Hearing to be Held Virtually

PUBLIC HEARING

STAFF PLANNER: Jessica McKinnon

STAFF RECOMMENDATION RE:

Docket HP-26-0001: Shelly's Cottages

Request: Boulder County Historic Landmark Designation
Location: 16188, 16190, 16194, and 16202 N St. Vrain Drive, in Section 11, T3N, R71W of the 6th Principal Meridian
Zoning: Forestry (F) Zoning District
Owner/
Applicants: Rockmont Investments, LLC
Agent: Heidi Campbell

PURPOSE

To determine if the nominated property qualifies for landmark designation, determine if the landmark application is complete, and formulate recommendations for the Board of County Commissioners.

BACKGROUND

An application for landmark designation of the former Shelly's Cottages has been submitted by the owner Rockmont Investments, LLC. The landmark proposal includes the following six buildings on four separate parcels:

1. The Office at 16190 N St. Vrain Drive
2. Cabin 1 at 16188 N St. Vrain Drive
3. Cabin 2 at 16202 N St. Vrain Drive
4. Double Cabin 1,
5. Double Cabin 2, and
6. Double Cabin 3 at 16194 N St. Vrain Drive

Known today as the Riverside Cabins, the properties have a long and rich history. Settlers Jabez and Elizabeth Billings received their patent for the land in 1891 and built several buildings including the log cabin that is part of the complex today but not part of the landmark application.

In 1893, the Billings sold 320 acres to William and Sarah Welch, and they added several more buildings, turning the place into the popular Welch Resort. Cabins 1 and 2 were built during the Welch's ownership, as well as a house just north of the log cabin that is privately owned and not part of this landmark application. Several notable guests reportedly stayed at the Welch Resort over the years including President Theodore Roosevelt, Ethel Barrymore, and Al Capone. Mr. Welch sold the property in 1937.

The property changed hands, names, and configurations several times over the next decade and a half before becoming Shelly's Cottages in 1952. The new owners, the Shellenbergers, added the Office, and the three Double Cabins. While only owned by the Shellenbergers less than 10 years, the properties continued under the name Shelly's Cottages, and the ownership of Henri and Pat Kinson, until the damage by the 2013 Flood Event closed the resort.

The name proposed for the landmark is Shelly's Cottages and not the more historic Welch Resort because most of the extant Welch buildings are not under the ownership of Rockmont Investments, LLC, while all of the buildings they own and are using as the Riverside Cabins were part of Shelly's Cottages.

In December 2023, a subcommittee of HPAB found the Riverside Cabins eligible for landmark status and gave their support for docket SU-23-0013: Riverside Cabins Lodge and Boundary Line Adjustment asking that a condition to landmark the properties be added to the docket's approval.

INTEGRITY

Cabins 1 and 2 were built circa 1906. They both have shingle cladding, and Cabin 1 also has scalloped shingles while Cabin 2 has board and batten siding. Their architectural integrity is unknown as staff has found no verified photos from the time they were built, although photos from c. 1905 show Welch Resort cabins with scalloped shingles and board and batten siding.

The Office, according to the 1966 Assessor's Card, was "originally [a] log cabin – has been added to since at various times."

Double Cabins 1, 2, and 3 cannot be accurately evaluated for integrity as staff found no photos from the time that they were built.

SIGNIFICANCE

The buildings may qualify for landmark designation under Criteria 1 and 4.

Criterion 15-501(A)(1) The character, interest, or value of the proposed landmark as part of the development, heritage, or cultural characteristics of the county;

The buildings, when considered together, are significant for their association with the development of the mid-20th century mountain resort industry in northern Boulder County.

Criteria 15-501(A)(4) The proposed landmark is an embodiment of the distinguishing characteristics of an architectural style valuable for the study of a period, type, method of construction, or the use of indigenous materials;

The buildings are significant as intact representatives of mid-20th century mountain resort architecture.

RECOMMENDATION

Staff recommends that the Historic Preservation Advisory Board APPROVE and recommend that the Board of County Commissioners approve Docket **HP-26-0001: Shelly's Cottages** under Criteria 1 and 4 and subject to the following conditions:

1. Alteration of any exterior feature of the structures will require review and approval of a Certificate of Appropriateness (CA) by Boulder County (note: applicable county review processes, including but not limited to Site Plan Review, may be required).
2. Regular maintenance which prolongs the life of the landmark, using original materials or materials that replicate the original materials, will not require review for a Certificate of Appropriateness, provided the Community Planning & Permitting Director has determined that the repair is minor in nature and will not damage any existing features. Emergency repairs, which are temporary in nature, will not require review (note: Depending on the type of work, a building permit may still be required.)





Community Planning & Permitting

2045 13th Street, Boulder, CO 80302 303-441-3930 www.bouldercounty.org

Vicinity

16188-16202 ST VRAIN

-  Subject Parcel
-  Municipalities
- Subdivisions**
-  Subdivisions

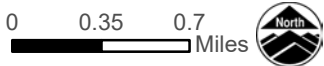
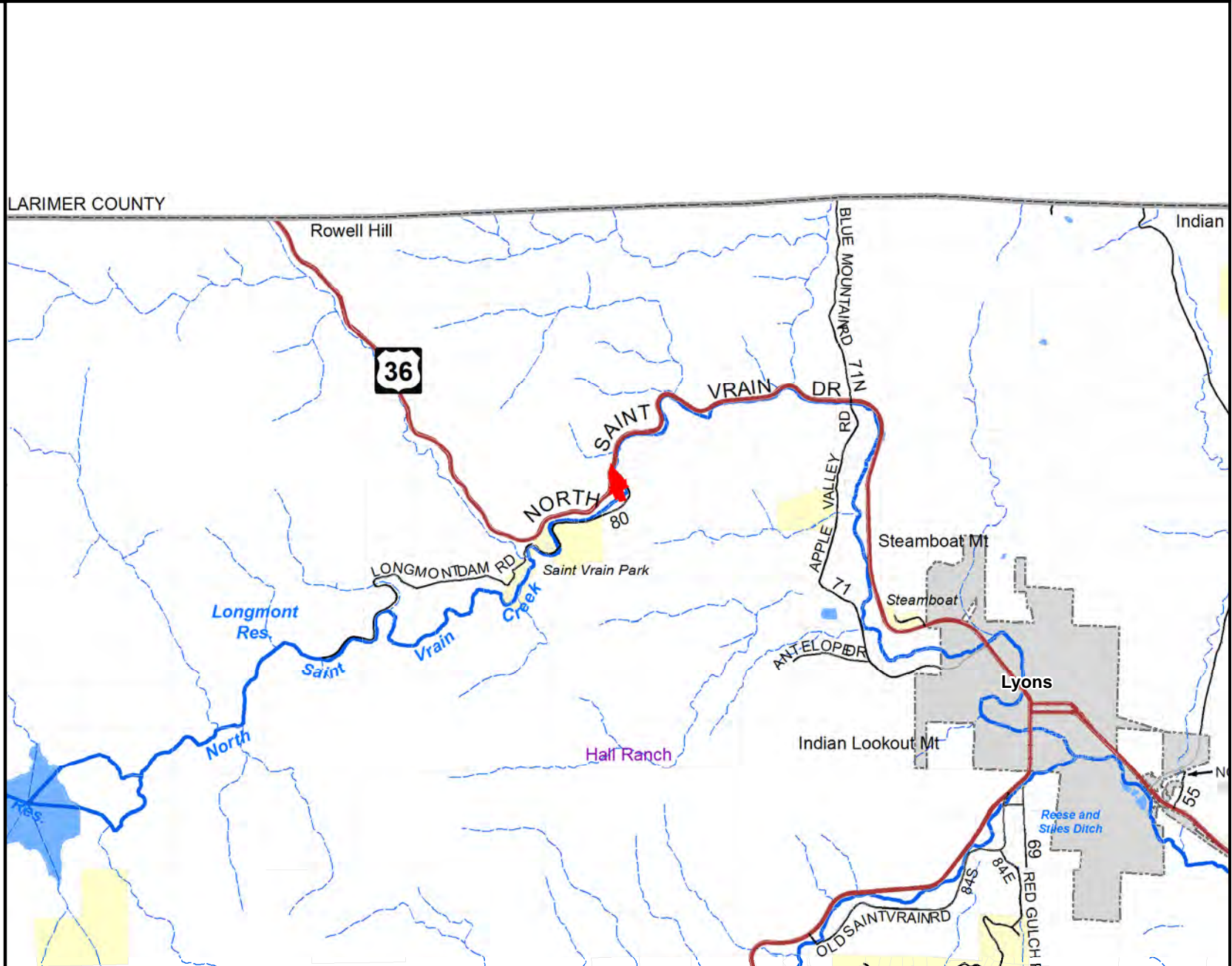

Area of Detail Date: 4/10/2023

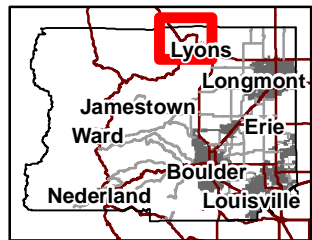

The user agrees to all Terms of Use set forth by Boulder County. For Terms of Use, please visit: www.bouldercounty.org/mapdisclaimer



Community Planning & Permitting

2045 13th Street, Boulder, CO 80302 303-441-3930 www.bouldercounty.org

Aerial

16188-16202 ST VRAIN

 Subject Parcel



0 0.05 0.1 Miles



Area of Detail Date: 4/10/2023

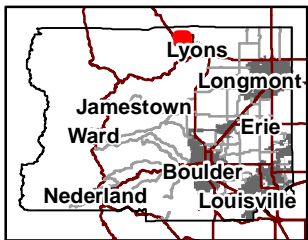

The user agrees to all Terms of Use set forth by Boulder County. For Terms of Use, please visit: www.bouldercounty.org/mapdisclaimer



Community Planning & Permitting

2045 13th Street, Boulder, CO 80302 303-441-3930 www.bouldercounty.org

Aerial

16188-16202 ST VRAIN

 Subject Parcel



0 0.015 0.03
Miles



Area of Detail Date: 4/10/2023

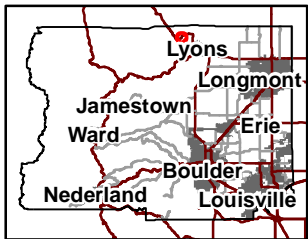

The user agrees to all Terms of Use set forth by Boulder County. For Terms of Use, please visit: www.bouldercounty.org/mapdisclaimer

★ Buildings included in the landmark

● Log cabin from Billings' occupation, not included in the landmark

▲ Some buildings from the Welch Resort, not included in the landmark

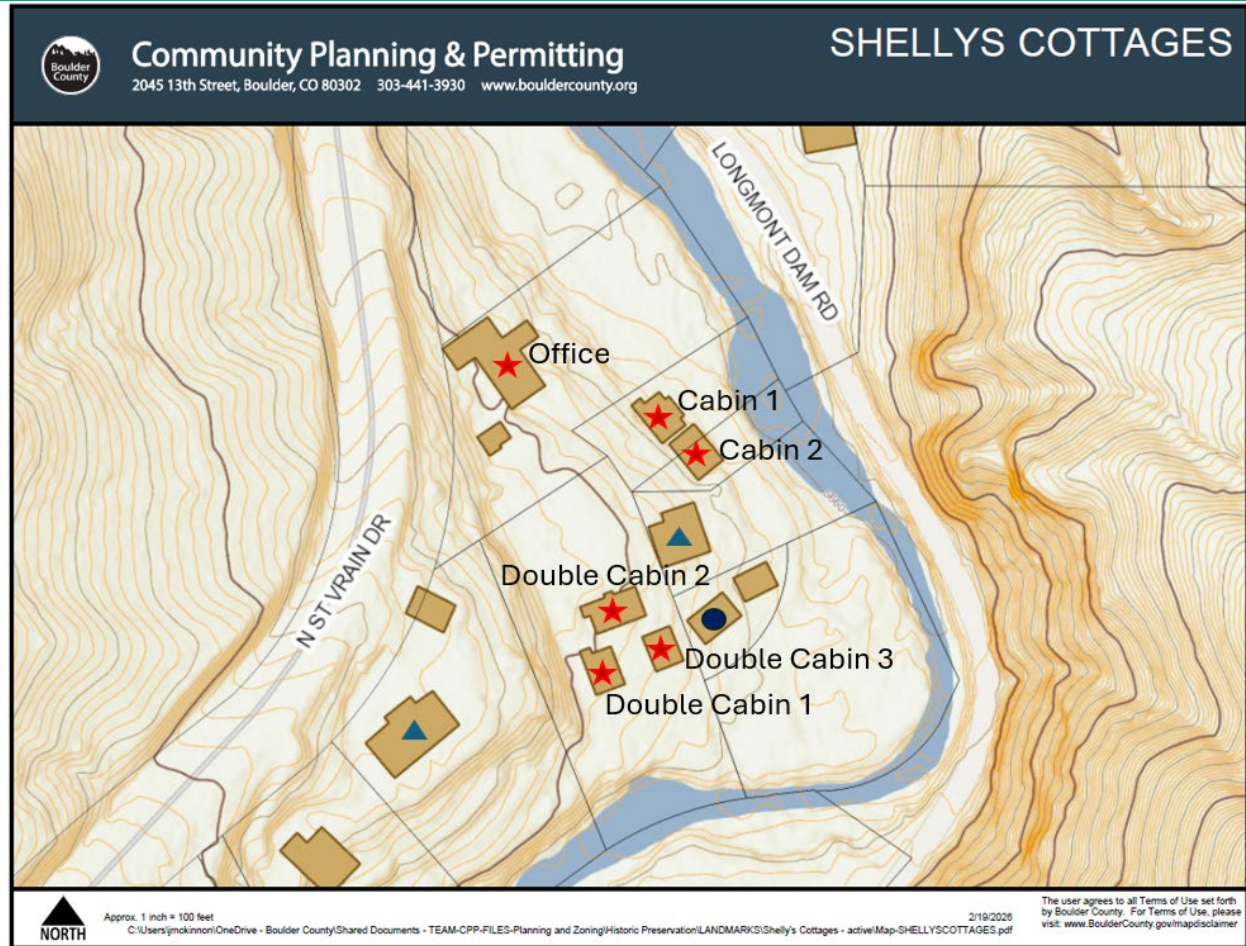



Boulder County Community Planning and Permitting Department

Courthouse Annex Building
2045 13th Street PO Box 471
Boulder, Colorado 80302
Phone: 303-441-3930
Email: historic@bouldercounty.gov
<http://www.bouldercounty.org/lu/>

Intake Stamp

Historic Landmark Nomination Form

Name of Property

Historic Name	Shelly's Cottages
Other Names	Welch Resort — Now Riverside Cabins
Historical Narrative	Vacation rental cabins cabins for people to get away and spend time in nature as well as exploring Lyons.

Location of Property

Address(s)		
16190 N St Vrain Dr.	16194 N St Vrain Dr.	
16202 N St Vrain Dr.	16188 N St Vrain Dr.	
City	State	Zip Code
Lyons	Colorado	80540

Classification

Property Ownership:

- Public
 Private
 Other

Category of Property:

- Structure
 Site
 District

Number of Resources Within the Property (sites and districts only):

6	Contributing Resources	Non-contributing Resources
---	------------------------	----------------------------

Narrative Describing Classification of Resources
Cabins see architectural narrative

Function or Use

Historic Functions
Vacation rentals to locals and tourists
Current Functions:
Vacation rental cabins - tourists to come relax in nature and explore Lyons

Resource Description

Narrative Describing Resource

See architectural narrative

Statement of Significance

Boulder County Criteria for Designation (check all that apply):

- The character, interest, or value of the proposed landmark as part of the development, heritage, or cultural characteristics of the county;
- Proposed landmark as a location of a significant local, county, state, or national event;
- The identification of the proposed landmark with a person or persons significantly contributing to the local, county, state, or national history;
- The proposed landmark as an embodiment of the distinguishing characteristics of an architectural style valuable for the study of a period, type, method of construction, or the use of indigenous materials;
- The proposed landmark as identification of the work of an architect, landscape architect, or master builder whose work has influenced development in the county, state, or nation;
- The proposed landmark's archaeological significance;
- The proposed landmark as an example of either architectural or structural innovation; and
- The relationship of the proposed landmark to other distinctive structures, districts, or sites which would also be determined to be of historic significance.

Areas of Significance

Tourism

Architecture

Period of Significance

Welch - 1914 - 1950 - Shelly's Cottages
Resort

Significant Dates

||

||

Significant Persons

N/A

Bibliographical References

See architectural narrative

Geographical Data

Legal Description of Property
Boundary Description
Boundary Justification

Property Owner(s) Information

Name Rockmont Investments- Micah Kohls			
City Thornton		Email Address micah@elevate-bnb.com	
State Colorado	Zip Code 80241	Phone Number 720-299-4852	
Signature 			

Preparer of Form Information

Name Heidi Campbell			
City Loveland		Email Address heidi@elevate-bnb.com	
State Colorado	Zip Code 80537	Phone Number 920-242-3237	
Signature 			

Photos, Maps, and Site Plan

see architectural narrative

For Office Use Only

Docket Number	Parcel Number
Assessor ID	Application Date

COLORADO CULTURAL RESOURCE SURVEY

Architectural Inventory Form

Page 1

- Date _____ Initials _____
- ___ Determined Eligible-National Register
- ___ Determined Not Eligible - National Register
- ___ Determined Eligible - State Register
- ___ Determined Not Eligible - State Register
- ___ Need Data
- ___ Contributing to eligible National Register District
- ___ Noncontributing to eligible National Register District



I. IDENTIFICATION

- | | | | |
|-------------------------------|--|-------------------|---------------------|
| 1. Resource number: | 5BL.12069 | Parcel number(s): | |
| 2. Temporary resource number: | NA | | 120111000017 |
| 3. County: | Boulder | | 120111002001 |
| 4. City: | Lyons vicinity | | |
| 5. Historic building name: | Welch Resort | | |
| 6. Current building name: | Shelly's Cottages | | |
| 7. Building address: | 16200 N St. Vrain Drive | | |
| 8. Owner name: | Troy Chartier and Kimberley K. Chartier | | |
| Owner organization: | NA | | |
| Owner address: | PO Box 740 | | |
| | Lyons, CO 80540 | | |

- | | |
|---|------------------------------|
| 44. National Register eligibility field assessment: | Not Eligible |
| Local landmark eligibility field assessment: | Individually Eligible |

Architectural Inventory Form

Page 2

II. GEOGRAPHIC INFORMATION

9. P.M.: **6th** Township: **3N** Range: **71W**
 1/4 of **NW** 1/4 of **NE** 1/4 of **SW** 1/4 of Section **11**
10. UTM reference zone: **13**
 Easting: **473382** Northing: **4454591**
 USGS quad name: **Lyons** Scale: **7.5**
 Year: **1978 photorevised**
11. Lot(s) : **NA**
 Addition: **na** Year of addition:
12. Boundary description and justification:
The property consists of 6 parcels of irregular shaped land with addresses 16188 through 16202 North St. Vrain Drive.
 Metes and bounds exist: **NA**

III. ARCHITECTURAL DESCRIPTION

13. Building plan (footprint, shape): **Rectangular Plan**
14. Other building plan descriptions:
15. Dimensions in feet (length x width):
16. Number of stories: **1**
17. Primary external wall material(s): **Wood/Horizontal Siding** Other wall materials:
0
18. Roof configuration: **Hipped Roof**
 Other roof configurations:
19. Primary external roof material: **Asphalt Roof/Composition Roof**
 Other roof materials:
20. Special features: **Porch**
Chimney
21. General architectural description:
The house is a rectangular plan, 1 story hipped roof building that faces east. The house features wood frame construction, painted white horizontal wood siding on the original section, wide particle board siding on the rear addition and a wrap around porch. A red sandstone chimney is located at the center of the roof's ridge line. The roof is light brown asphalt composition shingle. The foundation was not visible, but is most likely stone or concrete. The east elevation features the main entrance door with four 2/2 lite wood windows evenly spaced across the façade. The south elevation features four 2/2 lite wood windows on either side of the fireplace extension and a single entrance door into the rear addition. The west elevation features one 1/1 lite wood window and two wood picture windows with single 1/1 lite wood window on each windows side. The north elevation features the concrete block exterior chimney in the rear addition and three 2/2 lite wood windows in the original section of the building.
22. Architectural style: **Late 19th And Early 20th Century American Movements**
 Other architectural styles:
 Building type: **n/a**
23. Landscape or special setting features:

Architectural Inventory Form

Page 3

The property is located in the rural mountain area west of the Town of Lyons along the North St. Vrain River. The surrounding terrain was heavily impacted by the September 2013 flood. The property suffered major damage to the surrounding river corridor landscape that included the property between the buildings and river.

24. Associated buildings, features or objects:

- 1 : Type: **Uncle Tom's Cabin** Contributing?: **Contributing**
Describe: **This is a rectangular plan, side gabled roof log cabin that faces east. The cabin features a sandstone foundation with a crawl space, painted saddle notched log walls and a brown asphalt composition roof. A full width shed roof front porch covers the main entrance door and is flanked by large picture windows. A former second entrance door is located to the right of the current entrance door indicating the cabin at one time was a duplex. The opening is covered by log siding. The south elevation features a shed roof addition constructed of wood framing and log siding. There is a single entrance door and a 12 lite painted metal window at the ground level and a window in the gable end. The west elevation features a single entrance door covered by a small shed roof porch with a sandstone pad. Two painted 2/2 lite wood windows flank the door and a covered second entrance door can still be seen to the left of the current door. The north elevation features a 1/1 painted wood window and a covered entrance opening to the left covered with half log siding. The boarded crawl space entrance is also located on this elevation below the covered entrance opening.**
Records indicate this cabin was constructed circa 1883. In 1949, the cabin was sold as a separate parcel in to Rose Hamman
- 2 : Type: **Cabin 1** Contributing?: **Contributing**
Describe: **This is a rectangular plan, 1 story, side gabled roof cabin that faces northeast. The cabin features a sandstone foundation, wood frame construction with painted brown shingle and fishscale siding. The roof is grey asphalt composition shingle. A full length shed roof front porch is accessed by four sandstone steps. Constructed circa 1906-1907 during the William and Sarah Welch ownership. The rooms in the cabins are called the Cottonwood, Pines and Aspen.**
- 3 : Type: **Cabin 2** Contributing?: **Contributing**
Describe: **This is a rectangular plan, 1 story, side gabled roof cabin that faces northeast. The cabin features a sandstone foundation, wood frame construction with painted brown panel siding. The roof is brown asphalt composition shingle. A full length shed roof front porch is accessed by sandstone steps. Constructed circa 1906-1907 during the William and Sarah Welch ownership. The rooms in the cabins are called the Cottonwood, Pines and Aspen.**
- 4 : Type: **Double Cabin 1** Contributing?: **Contributing**
Describe: **This is a rectangular plan, 1 story, side gabled roof cabin that faces northeast. The cabin features wood frame construction, painted grey quarter sawn log siding and a light brown asphalt composition roof. A full width shed roof front porch covers the two main entrance doors and two large picture windows. The three similar double cabins form a U-shape plan. All were constructed circa 1952.**
- 5 : Type: **Double Cabin 2** Contributing?: **Contributing**
Describe: **This is a rectangular plan, 1 story, side gabled roof cabin that faces southeast. The cabin features wood frame construction, painted grey quarter sawn log siding and a light brown asphalt composition roof. A full width shed roof front porch covers the two main entrance doors and two large picture windows. The three similar double cabins form a U-shape plan. All were constructed circa 1952.**
- 6 : Type: **Double Cabin 3** Contributing?: **Contributing**
Describe: **This is a rectangular plan, 1 story, side gabled roof cabin that faces southwest. The cabin features wood frame construction, painted grey quarter sawn log siding and a light brown asphalt composition roof. A full width shed roof front porch covers the two main entrance doors and two large picture windows. The three similar double cabins form a U-shape plan. All were constructed circa 1952.**

Architectural Inventory Form

Page 4

7 : Type: **Garage** Contributing?: **Noncontributing**
 Describe: **The garage is a rectangular plan, 1 story, side gabled roof building that faces southeast. The garage appears to be less than 50 years of age.**

8 : Type: **Office** Contributing?: **Contributing**
 Describe: **The office is a irregular plan, 1 story, mixed roof type building. The foundation is most likely sandstone or rock with the siding a combination of siding at the lower level and painted tan quarter sawn log siding. The roof is light brown asphalt composition shingle. There is a mixture of windows and sizes as well as the undated additions to the original building. The Welch Resort book indicates part of this building was moved downhill from its original higher location to this current lower location in 1935. No details are provided. The additions possibly date from 1952.**

IV. ARCHITECTURAL HISTORY

25. Date of Construction: Estimate: Actual: **1907**
 Source of Information: **Berg, Denise V. The Welch Resort: A Hidden Treasure of Boulder County. Lyons, Colorado, Kumpfenberg Ventures LLC, 2006.**
26. Architect: **unknown architect**
 Source of information: **Berg, Denise V. The Welch Resort: A Hidden Treasure of Boulder County. Lyons, Colorado, Kumpfenberg Ventures LLC, 2006.**
27. Builder: **unknown builder**
 Source of information: **Berg, Denise V. The Welch Resort: A Hidden Treasure of Boulder County. Lyons, Colorado, Kumpfenberg Ventures LLC, 2006.**
28. Original Owner: **William and Sarah Welch**
 Source of information: **Berg, Denise V. The Welch Resort: A Hidden Treasure of Boulder County. Lyons, Colorado, Kumpfenberg Ventures LLC, 2006.**
29. Construction history:
According to Boulder County Assessor records, this house was constructed in 1907. An analysis of the style, building materials, and other historical records corroborates these dates of construction. An undated wood framed west addition with concrete block chimney was added to the original house after the building was moved from its original location. Other known changes include the asphalt roof, metal storm windows, metal storm door, the addition of a small bump-out to install a wood stove or fireplace on the south elevation, stone and plywood siding under the porch. A transom window may have been boarded up over the main entrance door.
30. Location: **moved** Date of move(s) **Moved from the hillside above around 1935.**

V. HISTORICAL ASSOCIATIONS

31. Original use(s): **Single Dwelling**
32. Intermediate use(s): **Single Dwelling**
33. Current use(s): **Single Dwelling**
34. Site type(s):
35. Historical background:

The property on which the buildings reside were homesteaded by Jabez and Elizabeth Billings. They received the patent under the 1820 Cash Sale Act on July 28, 1891. They named their property Camp Billings. Several buildings were constructed that included small stone cabin, long stone stable, large barn and log cabin known as "Uncle Tom's Cabin." In 1893, Billings sold 320 acres of Camp Billings to William A. & Sarah Welch. Over the next several years the Welch's developed the resort with

Architectural Inventory Form

Page 5

numerous buildings including a lodge, casino, dining hall, trout ponds, apple orchards, bandstand, ice house and cabins in which guests could stay.

William Welch was born on August 21, 1861, most likely in Pennsylvania to Aristides and Rachel Henrietta Jackson Armstrong. One of three sons, William "Billy", graduated from law school and moved to Boston and married Sarah Capson in 1882. Coming from a wealthy family, Welch most likely purchased the property from the money he inherited from his father's estate. The resort was fully operational by 1897 with a toll road leading to the resort. In 1907 F.O. Stanley paid Welch \$3,000 for a right of way through a one mile section of is resort to build a road up to Estes Park. Several decades later, Welch sold the land for the right of way to build US Highway 36.

Although never specifically design to serve as a tuberculosis sanatorium, the resort did receive visitors who sought relief in the mountain air. The resort featured screened in porches, tents along the river and a special shower imported from Europe.

Over the years the Welch resort grew in popularity and size. In addition to the locals who came during the weekends, tourists from out of state came to the experience the mountain setting, often staying for longer periods of time that ranged from weeks to months. In the July 24, 1920 Lyons Recorder, it stated that the resort "is one of the most popular places on the North Fork, and is run this season under new management and clean principals." (The Welch's leased the resort for others to manage).

Although the original guest register is missing, the most famous guests reportedly to have stayed at the resort include President Theodore Roosevelt, Dr. Walter Reed (discovered of the cure for yellow fever), Ethel Barrymore, and Al Capone.

In 1903 the Welch's purchased the 940 Arbuckle Resort, located further up the North St. Vrain River and later the Big Elk Ranch near Allenspark. The Arbuckle Ranch later was purchased by Edwin Boinay and later owned by his niece Lillian Trevarton.

Sarah Welch died on July 25, 1936 at the age of 87 and is buried at the Crown Hill Cemetery in Denver. In July 1937 Billy sold the property to Mr. & Mrs. Oscar Shirk and Nettie Miller who renamed the resort The St. Vrain Mountain Ranch Resort. Billy moved to Denver and died three months later on May 27, 1938 at the age of 77. He is buried next to Sarah, both in unmarked graves. It is reported he died penniless.

The resort was bought and sold over the years and the property and buildings subdivided. The Casino and lodge were purchased in 1945 by Mr. & Mrs. Almore Pagh to run as the restaurant The Copper Kettle. The dining hall burned down in 1946 while the resort was being run by Ray Buchan and Joseph Zunz as the B Bar Z Guest Ranch The Pags sold the lodge and other buildings in 1949 to Willis and Herbert Kelso. In 1949 the Kelsos sold "Uncle Tom's Cabin and the Honeymoon Cottage (this building burned in 1964) to Rose Hamman.

In 1952 E.B. Shellenberger and his wife bought the resort and renamed it Shelly's Cottages." They added six new cabins and the main house that serves as the resort's offices. In 1961 the Shellenbergers sold to Charles and Evelyn Pigeon. In 1964 Henri and Pat Kinsen bought the property. In 2000 Kim and Troy Chartier purchased the property. The Chartiers purchased the Casino and Uncle Tom's cabin in 2012.

36. Sources of information:

Berg, Denise V. The Welch Resort: A Hidden Treasure of Boulder County. Lyons, Colorado, Kumpfenberg Ventures LLC, 2006.

Berg, Denise V. Double Gateway to the Rockies, Lyons, Colorado, 1900s. Lyons, Colorado, Kumpfenberg Ventures LLC, 2009.

Benedict, Diane Goode. Birth of a Quarry Town: 1800s Lyons Colorado. Lyons, Colorado, Applications Plus, 2002.

Boulder County Assessor Real Estate Appraisal Card Rural Master Index. Carnegie Branch Library for Local History, Boulder, Colorado.

Weaver, Frank. They Came by Covered Wagon: A History of the Billings Family. Lyons, Colorado, The New Lyons Recorder, 1977.

Architectural Inventory Form

Page 6

VI. SIGNIFICANCE

37. Local landmark designation: Yes No

Designation authority:

Date of designation:

38. Applicable National Register criteria:

- A. Associated with events that have made a significant contribution to the broad pattern of our history.
- B. Associated with the lives of persons significant in our past.
- C. Embodies the distinctive characteristics of a type, period, or method of construction, or represents the work of a master, or that possess high artistic values, or represents a significant and distinguished entity whose components may lack individual distinction.
- D. Has yielded, or may be likely to yield, information important in history or prehistory.
- Qualifies under Criteria Considerations A through G (see manual).
- Does not meet any of the above National Register criteria.

Boulder County Standards for Designation:

- Does not meet any of the Boulder County criteria for designation
- Criterion 1
- the character, interest, or value of the proposed landmark as part of the development, heritage, or cultural characteristics of the county;
- Criterion 2
- the proposed landmark as a location of a significant local, county, state, or national event;
- Criterion 3
- the identification of the proposed landmark with a person or persons significantly contributing to the local, county, state, or national history;
- Criterion 4
- the proposed landmark as an embodiment of the distinguishing characteristics of an architectural style valuable for the study of a period, type, method of construction, or the use of indigenous materials;
- Criterion 5
- the proposed landmark as identification of the work of an architect, landscape architect, or master builder whose work has influenced development in the county, state, or nation;
- Criterion 6
- the proposed landmark's archaeological significance;
- Criterion 7
- the proposed landmark as an example of either architectural or structural innovation;
- Criterion 8
- the relationship of the proposed landmark to other distinctive structures, districts, or sites which would also be determined to be of historic significance

39. Area(s) of Significance: **Entertainment/Recreation**40. Period of Significance: **1893-1937**41. Level of significance: National: State Local

42. Statement of significance:

This property is historically significant for its association with the development of the late 19th and early 20th century mountain resort industry in western Boulder County. Located west of the Town of Lyons and on the road to Estes Park, this area along the North St. Vrain Creek became a haven for numerous summer resorts attracting visitors to enjoy its natural

Architectural Inventory Form

Page 7

beauty.

43. Assessment of historic physical integrity related to significance:

The house exhibits a high level of physical integrity relative to the seven aspects of integrity as defined by the National Park Service and the Colorado Historical Society: location, setting, design, materials, workmanship, feeling, and association. The building retains sufficient physical integrity to convey its historical and architectural significance.

VII. NATIONAL REGISTER ELIGIBILITY ASSESSMENT

44. National Register eligibility field assessment: **Not Eligible**
 Local landmark eligibility field assessment: **Individually Eligible**
45. Is there National Register district potential? Yes No
- Discuss:
 If there is National Register district potential, is this building contributing: Yes No N/A
46. If the building is in existing National Register district, is it contributing: Yes No N/A

VIII. RECORDING INFORMATION

47. Photograph numbers): **Shellys digitals**
 Negatives filed at: **Boulder County Parks & Open Space Department
 5201 St. Vrain Rd.
 Longmont CO 80503**
48. Report title: **Historic Sites Survey**
49. Date(s): **10/17/13**
50. Recorder(s): **Carol A. Beam**
51. Organization: **Boulder County Parks & Open Space Department**
52. Address: **5201 St. Vrain Rd.
 Longmont CO 80503**
53. Phone number(s): **(303) 678-6272**



5BL12069
16188 & 16200 N. ST. VRAIN DR. LYONS
CABIN 1 (RIGHT) & CABIN 2 (LEFT)
E ELEVATION
AUGUST 2013

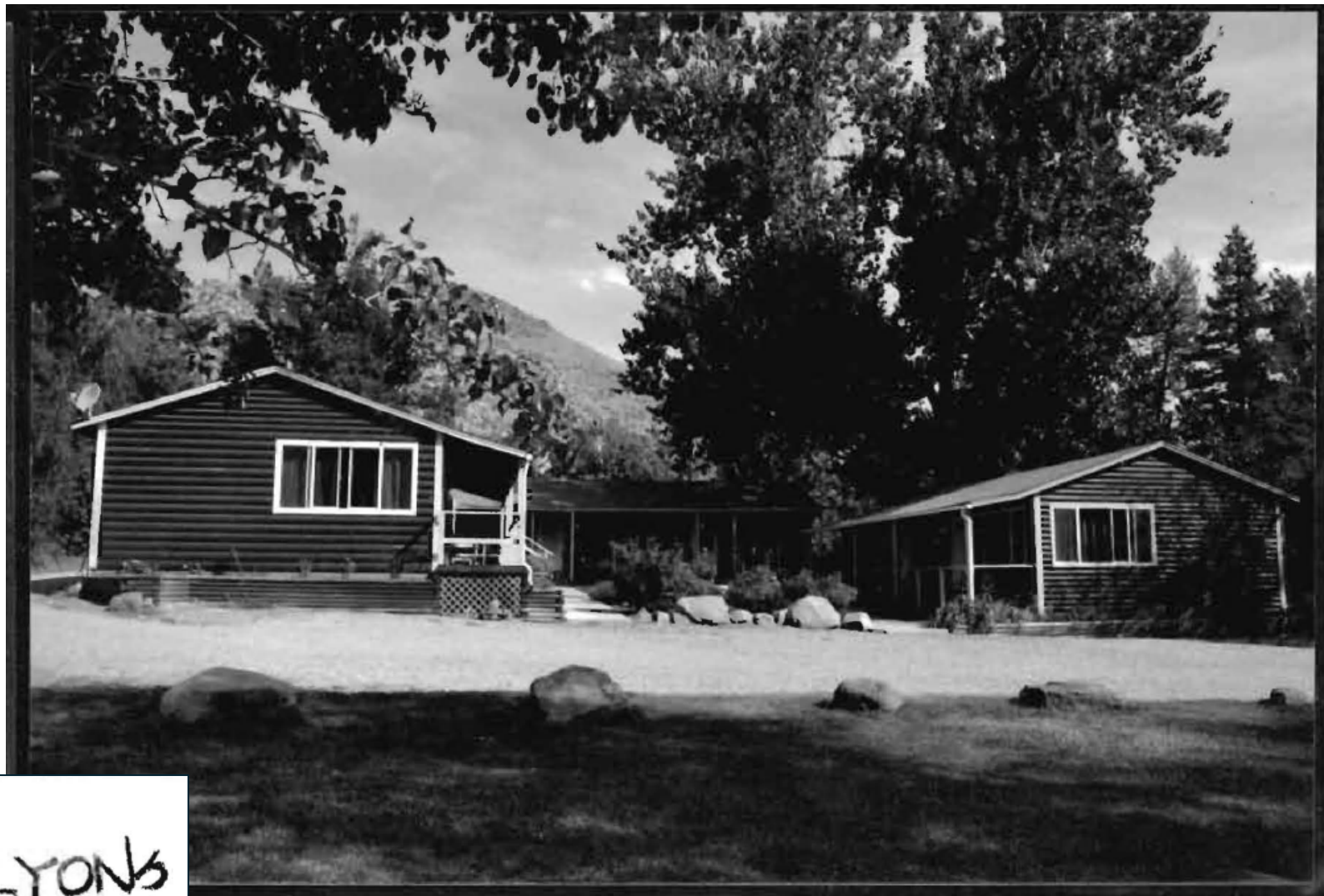

5BL.12069
16194 N. ST. VRAIN DR., LYONS
DOUBLE CABIN 1, 2 & 3
S ELEVATION
AUGUST 2013

Office, 2026



HP-26-0001: Shelly's Cottages



Office, north side, 1966
Assessor's card



Office, north side, 2026

Cabin 1, 2026



Cabin 2, 2026



Likely Cabins 1 and 2, c. mid-1930s, based on 1930s Packard ->



Cabins unknown, 1900-1909 based on staff assessment of clothing, Carnegie Library



HP-26-0001: Shelly's Cottages

Double Cabin 1, 2026



Double Cabin 2, 2026



Double Cabin 3, 2026



2013



HP-26-0001: Shelly's Cottages